



ABF-2000
BALE FEEDER

Operators Manual



Reese Engineering Ltd

Palmerston North, New Zealand

Telephone: +64 6 357 9323

Facsimile: +64 6 354 3155

www.reeseagri.com



Agrispred™ is a trademark owned 100% by Reese Engineering Limited

BaleBug™ is a copyright design



Contents

OWNER INFORMATION	3
PRODUCT DESCRIPTION	4
ORDERING SPARE PARTS	4
RECEIVING DELIVERY	4
SAFETY PRECAUTIONS.....	5
SAFETY FIRST	6
OPERATE YOUR MACHINE SAFELY	6
WEAR PROTECTIVE GEAR	6
BE SAFE WITH CHEMICALS	7
DISPOSE OF WASTE PROPERLY	7
LOADING BALES.....	8
TRANSPORTING BALES	9
FEEDING OUT SET-UP	10
FEEDING OUT	11
MAINTENANCE	12
CONVEYOR DRIVE CHAINS	12
BEARINGS AND GREASE POINTS	12
HYDRAULIC DRIVE MOTOR	12
ASSEMBLY PARTS	13
ASSEMBLY PART NUMBERS	14
CONVEYOR ASSEMBLY	15

Please read and understand this manual before attempting to operate the Bigeasy[™] bale feeder.



Owner Information

Congratulations on the purchase of your new AGRISPRED™.

The AGRISPRED™ range of fertiliser spreaders and bale feeders has been designed and manufactured with the discerning farmer in mind. Having regarded ever-increasing costs of farm machinery today, our company has attempted to provide long-term durability by using the finest materials in the construction of the spreaders and bale feeders.

This manual deals with the assembly, operation and maintenance of the Bigeasy™ bale feeder. Read it thoroughly before attempting to use your bale feeder. If you are still unsure about any aspect of the Bigeasy™ ask the dealer who supplied the machine to explain any unclear points.

Your AGRISPRED™ Dealer is:

Name í

Address í

 í

Phone No í

Date Machine Purchased í

Model No í

Serial No



Product Description

Model	ABF-2000
Capacity	2 Bales / up to 2 tonne total
Conveyor Drive	Hydraulic Motor
Hydraulic Requirements	2 banks 2000psi minimum
Length	2.05m (with forks up)
Height	1.95m (with forks up)
Width	2.2m
Weight	650kg

Feeds Out: All round hay and silage bales up to 1 tonne max per bale

***Tractor:** Any tractor with adequate hydraulics and load carrying capacity, please refer to your tractor's linkage loading specs.

Ordering Spare Parts

Always order spare parts for your Bigeasy[™] through your authorised Agripred[™] dealer using the Agripred[™] part number and descriptions given in the parts manual.

Please include:

- Quantity required
- Model number
- Machine serial number

The serial number can be found on the plate attached to your Bigeasy[™] base frame.

Receiving Delivery

Carefully check for any damage that may have occurred during transit, and if necessary, ensure that a claim is lodged with the common carrier concerned prior to accepting delivery.

*Reese Agri, Agripred or its associated companies and employees accept no liability in regard to use of any tractor that is not suited to the task of operating this implement.

The operator and his/her employees must take full responsibility for their tractor of choice and completely understand the factory linkage loading specifications of that vehicle.



Safety Precautions

Be aware of your tractors or other farm vehicles load carrying capacity, excess weight whether attached or placed on a farm vehicle can dramatically change the handling characteristics.

- Make sure all persons are well clear of the Bigeasy™ whenever it is to be operated
- Make sure that the tractor is up to the task as bales can weigh in excess of 800kg and the Bigeasy™ is 650kg so it is important to understand the load carrying capacity of the tractor being used especially if 2 bales are to be carried.
- Never exceed 10 kph when 2 bales are loaded.
- Ensure that all moving parts are kept free from feed build-up as this can affect the overall performance of the machine.
- Under no circumstances should any person ever ride on the machine
- The Bigeasy™ is intended for farm use only and should not be used for any task other than loading and feeding out bales
- Under no circumstances should any load be placed or attached to the Bigeasy™ other than bales
- Do not overload the forks or use for any task other than lifting and loading bales
- Ensure that if any work, maintenance or cleaning is to take place that the Bigeasy™ is shut down and fully stoped; this should include shutting down the tractor.
- Always check that the tractors linkages are in good condition and adjusted for minimal sway when attached to the Bigeasy™

The user of this Agrispred™ Bigeasy™ is fully responsible at all times for the safety of any persons that may be in the vicinity of the implement. Use of the Bigeasy™ implies that the operator has read and fully understands the safe operation of this implement. Other conditions that may affect safe operation include but are not limited to: weather, ground conditions, land contour, visibility, bale weight and size, tractor and linkages, operator skill/experience.



Safety First

Keep your machine in proper working condition. Unauthorized modifications to the machine may impair the function and/or safety and affect machine life.

If you do not understand any part of this manual and need assistance, contact your AGRISPRED™ dealer.

OPERATE YOUR MACHINE SAFELY

Be careful when operating machine to avoid injury.

Serious injury or death can result from contact with electric lines. Use care when moving or operating the machine near electric lines to avoid contact.



Be careful when operating on hillsides, tractors/ATV's can tip sideways if it strikes a hole, ditch or other irregularity.

Permit only one person, the operator, on tractor/ATV platform while tractor/ATV is in operation. Keep riders off. They are subject to injury such as being struck by foreign object and being thrown off the machine. They also obstruct the operators view.

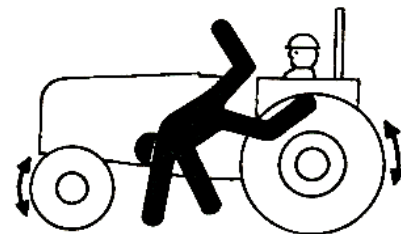

WEAR PROTECTIVE GEAR

Wear close fitting clothes and safety equipment appropriate to the job.

Wear suitable hearing protective device as prolonged exposure to loud noise can cause impairment or loss of hearing.



Wear safety gloves when working with any machinery, as there can be sharp edges.

Operating equipment safely requires the full attention of the operator. Do not wear radio headphones while operating machine.



BE SAFE WITH CHEMICALS

Direct exposure to agricultural and hazardous chemicals can cause serious injury. Potentially hazardous chemicals used with AGRISPRED™ equipment include such items as lubricants, coolants, fertilizer, paint and adhesives. If in doubt, contact your local AGRISPRED™ dealer for information about chemical safety and first aid procedures.

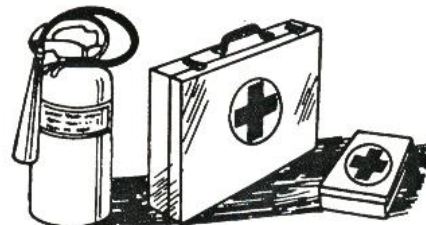

Keep all parts in good condition and properly installed. Fix damage immediately. Replace worn or broken parts. Remove any build-up of grease, oil, or debris.

Remove paint before welding or heating. Avoid potentially toxic fumes and dust when sanding, repainting or welding. Do all work outside in a well-ventilated area. Dispose of paint and solvent properly.



Avoid heating near pressurized fluid lines or other flammable materials. Pressurized lines can be accidentally cut when heat goes beyond the immediate flame, which could result in severe burns to yourself and bystanders.

Avoid high-pressure fluids. Escaping fluid under pressure can cause injury. Relieve pressure before disconnecting hydraulic or other lines.

DISPOSE OF WASTE PROPERLY

Improper disposing of waste can threaten the environment and ecology. Use leak-proof equipment when draining fluids. Do not use food or beverage containers that may mislead someone into drinking from them.



Do not pour waste onto the ground, down a drain, or into any water source. Use the manufactures directions on the correct way to recycle or dispose of waste



Loading Bales

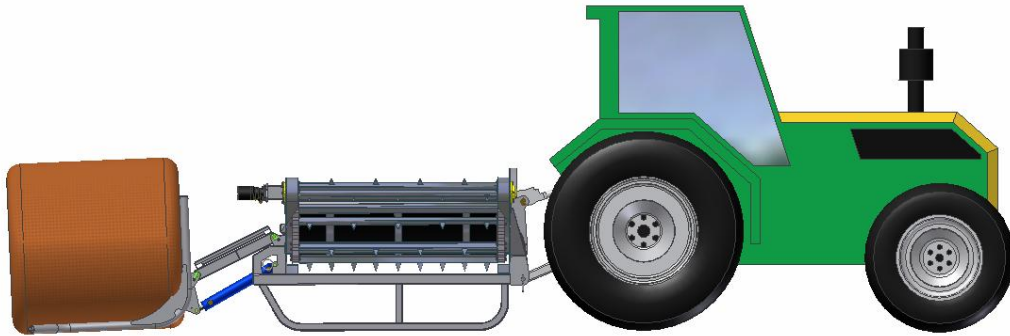

Lower the Bigeasy™ so that the skids are in contact with the ground or very close to it, this will ensure that the lift forks are the correct height when lowered to slide under the bale for safe effective loading.

The forks should be driven under the bale until the bale makes contact with the upright of the lift forks.

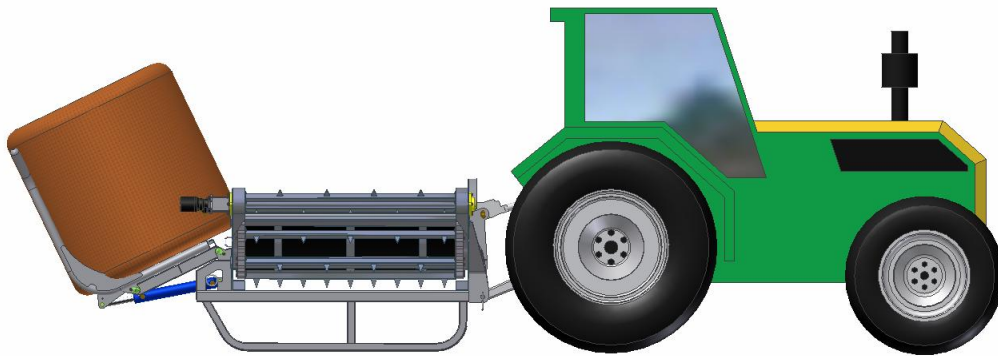

Lift bale clear of the ground and to the desired height for easy removal of wrap and string.

Note: if the bales are very soft and falling apart the bale should be unwrapped just before loading onto the conveyor table (ensure all string and wrap is removed before feeding out)

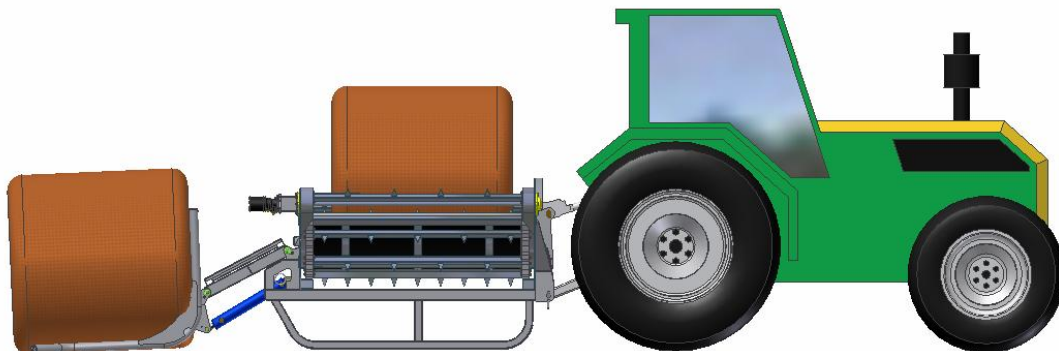

Once the first bale is loaded a second may be picked up for transport to the desired paddock or feed pad (depending on the tractor's linkage loading capacity)



Transporting Bales

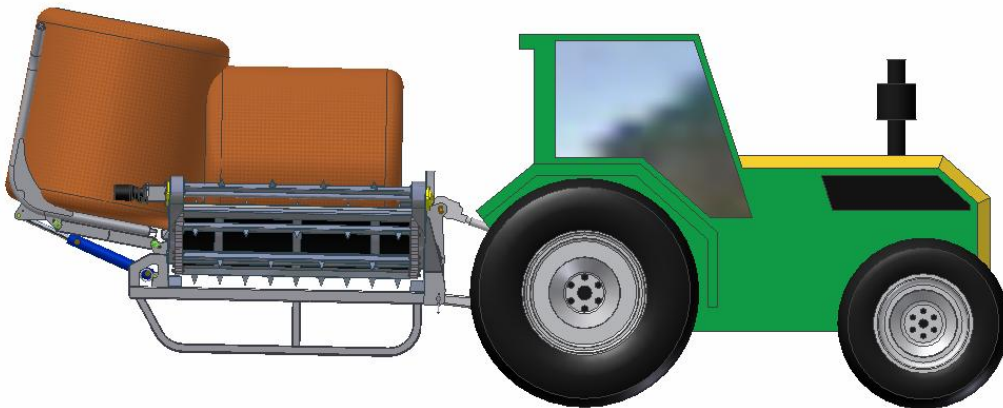

If 2 bales are to be carried the second should be lifted up to make firm contact with the first, this will aid in stability and load transfer.

The skids should be as high off the ground as the linkage will allow during transport, as this will minimize the chance of the Bigeasy[™] making contact with the ground over rough terrain.

Note: please refer to the linkage loading specs of the tractor being used before attempting to transport 2 bales as some may weigh in excess of 800kg and the Bigeasy[™] is 650kg, it is also important to keep speed to a minimum as shock loading can have a dramatic effect on the handling characteristics of the tractor being used, 10kph is recommended unless the ground conditions are very flat.

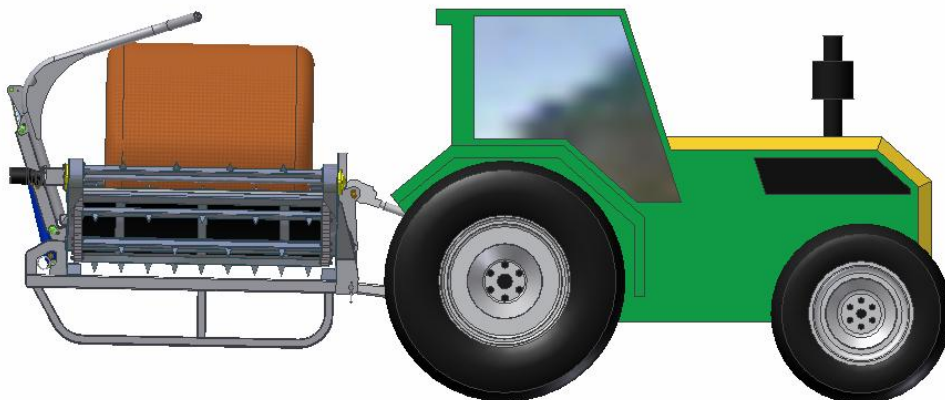

When transporting one bale the lift forks should be in the fully upright position (ram fully extended) this will ensure that the bale is trapped on the conveyor table and is stable during the navigation of rougher terrain.

Important: Linkage sway chains should always be adjusted to minimize sideways movement of the Bigeasy[™] at all times.



Feeding out set-up

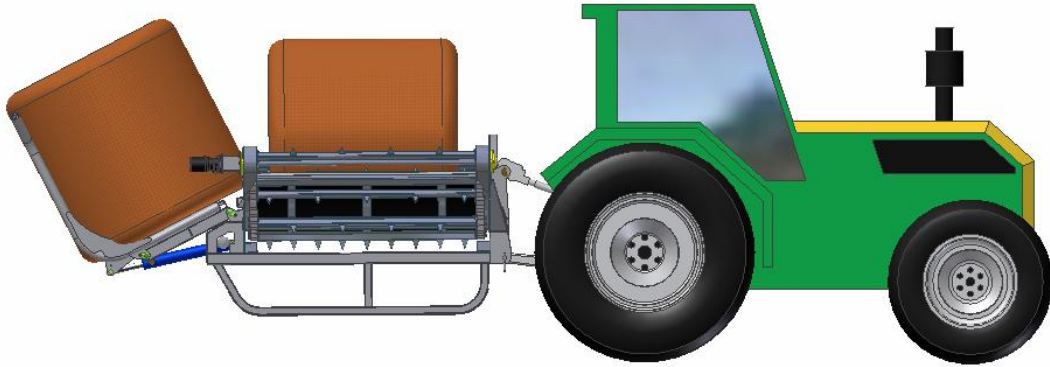

When preparing to feed out (if carrying 2 bales) the second bale should be lowered to a point where it is stable on the forks and not interfering with the bale which will be rotating. The Bigeasytm should also be as level as possible with the skids well clear of the ground, this will encourage the bale to sit in the middle of the conveyor table which will ensure the even and smooth distribution of feed and overall performance.

Note: with the second bale lowered to this position it will be less stable over rougher terrain so speed considerations and operator awareness is very important.



Feeding out

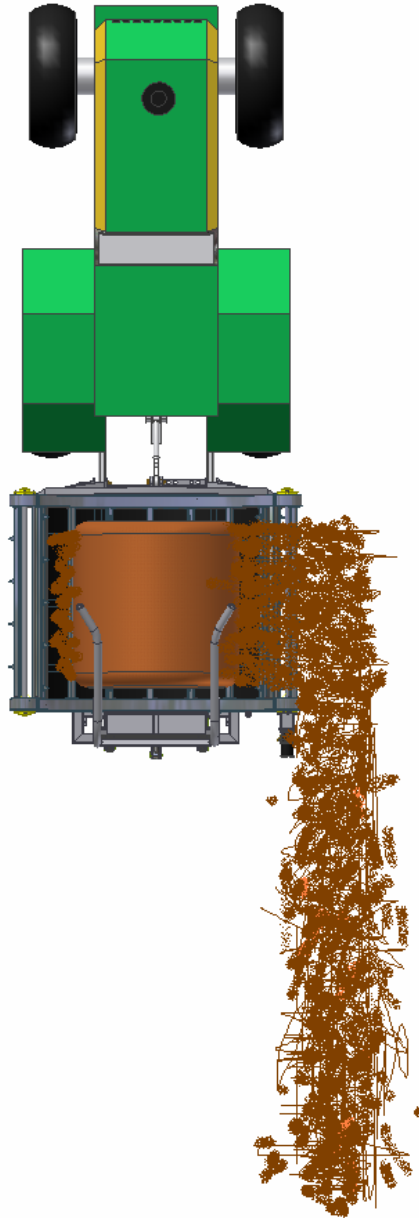

The speed of the tractor and hydraulic flow to the conveyor motor are the governing factors that determine the width and placement of feed, this is up to personal preference and application requirements.

Note: some tractors will over speed the conveyor with hydraulic flow set to maximum so it is recommended that the flow be backed off to approximately 25 ó 30 litres per minute then set to the desired feed out speed from there.



Maintenance

Conveyor Drive Chains

The conveyor drive chains should be trouble free as they are of heavy construction (12000 lb rated) and also have a corrosion resistant coating but may require some oil from time to time if squeaking is heard or if the Bigeasytm is to be left outside for extended periods.

Note: when new the conveyor chains may be noisy for the first few hours this is normal and is the bedding in period.

Bearings and grease points

The sprocket shaft bearings will require regular greasing but it is very important not to over grease as this can be damaging. The fork assembly and grab table assembly has 6 grease points at the pivots and should also be regularly lubricated.

The **Grub Screws** securing the bearings to the sprocket shaft will require checking after the first 5 hours operation and tightening if necessary.

Hydraulic Drive Motor

The hydraulic drive motor should give years of trouble free service due to its high torque and robust construction. The tractors hydraulic system should be in very good order (clean well filtered oil) this will ensure the drive motors longevity.

Note: it is also important to regularly check the hydraulic motor mount flange bolts as they may need tightening from time to time due to the high torque loading in both directions.



Assembly Parts

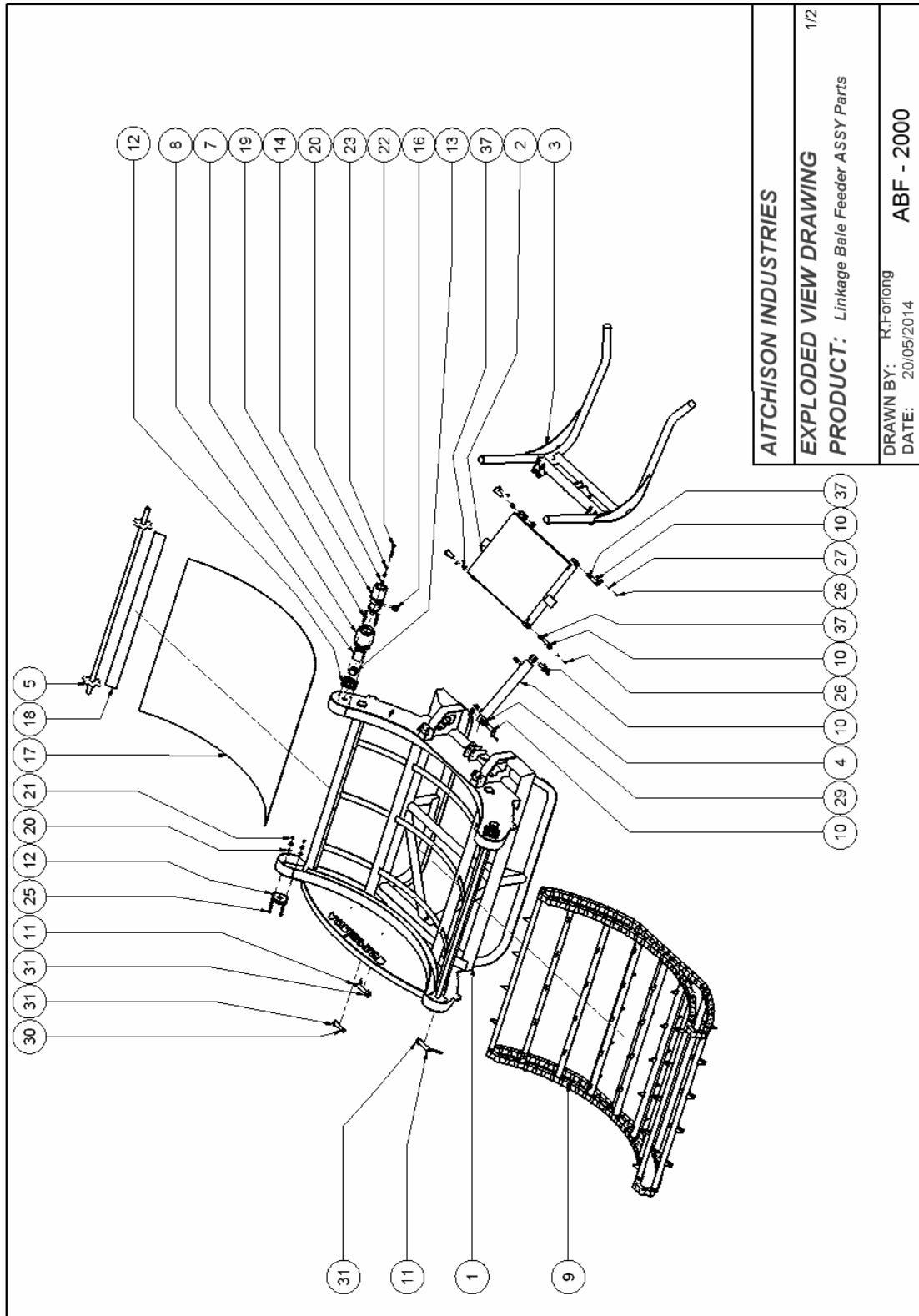



Assembly Part Numbers

Parts List				Parts List			
ITEM	QTY	DESCRIPTION	PART NUMBER	ITEM	QTY	DESCRIPTION	PART NUMBER
1	1	Linkage Bale Feeder Base Chassis Complete ASSY	A4730-ASSY	21	18	12mm HD Flat Washer	9054
2	1	Balebug Table Assy	A4727	22	16	M12 Nyloc Nut	9151
3	1	Grab Table ASSY	A4701	23	2	M12 x 35 Bolt	8510H
4	1	Spike ASSY	A4702	24	2	12mm Spring Washer	9052
5	1	Bale Buggy Ram 17" Stroke	A4700-02	25	1	10 x 50 Roll Pin	TO-204112
6	1	Sprocket Shaft Drive Side ASSY	A4714	26	12	M12 x 40 Bolt	8503H
7	1	Sprocket Shaft Non Drive Side ASSY	A4713	27	6	M8 x 25 Bolt	8305H
8	1	Motor Mount ASSY	A4712	28	6	8mm Flat Washer	9031
9	1	Motor Drive	A4711	29	6	M8 Nyloc Nut	9105
10	1	Conveyor Assembly	A4706-ASSY	30	2	Ram Mount Spacer	A4700-10
11	6	Ram Pin Assy	A4710	31	1	Top Link Pin B76	A23189-02
12	2	AIL Cat 2 Hitch Pin	A2327	32	3	Linch Pin	9288
13	4	UCF 207 Bearing / Housing	92261 / 92262	33	2	1/2BSPT to 3/8BSPP Male Nipple	H3217
14	1	Motor Drive Inner	A4700-04	34	6	M6 Grease Nipple Straight	9323
15	1	MTA OR400C Motor	A4704-05	35	2	M10 Nut	9141
16	1	Hydraulic Hose Retainer	A4726-27	36	2	M10 x 40 Bolt	8416H
17	2	1/2BSPT to 1/2BSPP Male Nipple	H38101	37	12	4.8 x 12 SS Pop Rivet	9301
18	1	Plastic Bed	A4700-03	38	8	16DU12 1"x 1-1/8" x 3/4" DU Bush	A4701-08
19	2	Plastic Bed Top Retaining Strip	A4700-09	39	1	Linkage Bale Feeder Hydraulic Hose Kit	A4732
20	4	M12 x 45 Bolt	8504H				

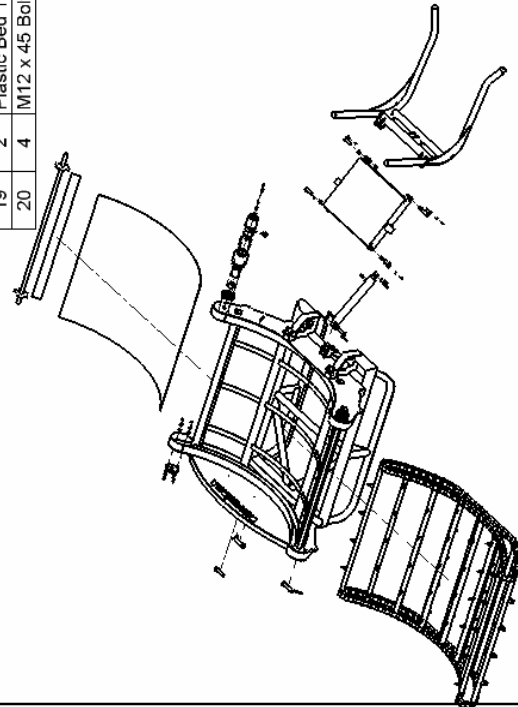

AITCHISON INDUSTRIES

EXPLODED VIEW DRAWING

PRODUCT: Linkage Bale Feeder ASSY Part Numbers

DRAWN BY: K.F. Forlong
DATE: 20/05/2014
ABF - 2000



Conveyor Assembly

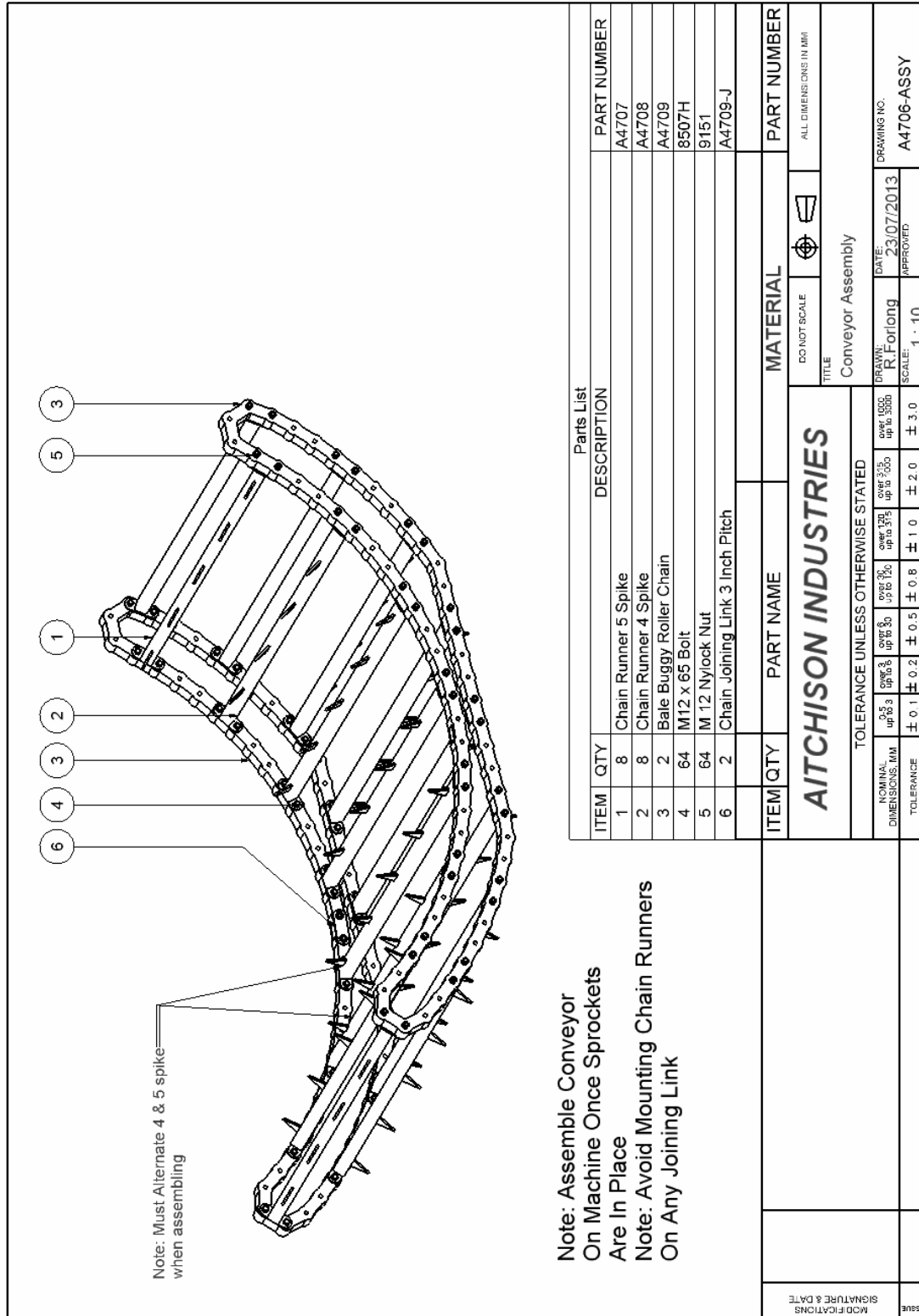

COPYRIGHT: THIS DRAWING IS THE PROPERTY OF AITCHISON INDUSTRIES. IT MAY NOT BE REPRODUCED IN WHOLE OR IN PART WITHOUT THEIR WRITTEN PERMISSION.